

Smarter technology for all

Servicing the Lenovo ThinkSystem ST50 V2 server

ES72326
May 2022



Prerequisites

- ES51757B – Introducing ThinkSystem tools
<https://lenovoedu.lenovo.com/course/view.php?idnumber=ES51757B>
- ES41759B – ThinkSystem problem determination
<https://lenovoedu.lenovo.com/course/view.php?idnumber=ES41759B>
- ES42108B – ThinkSystem V2 architecture introduction
<https://lenovoedu.lenovo.com/course/view.php?idnumber=ES42108B>
- ES42190 – Servicing the ThinkSystem 4350/5350/9350 RAID/HBA series adapters
<https://lenovoedu.lenovo.com/course/view.php?idnumber=ES42190>

Objectives

After completing the course, you will be able to:

- Describe the ThinkSystem ST50 V2 server
- Describe the server features and specifications
- Identify the server diagram
- Describe the problem determination and VPD update procedures for the ST50 V2

What's new

- Updated memory feature – refer to the [Memory features page](#)
- New UEFI BIOS firmware upgrade procedure – refer to the [UEFI BIOS firmware upgrade procedure page](#)

Product overview

Product description and front, rear, and inside views

The Lenovo logo is positioned in the top right corner of the slide. It consists of the word "Lenovo" in a white, sans-serif font, oriented vertically. The text is set against a rectangular background with a vertical color gradient that transitions from green at the top to blue at the bottom.

Lenovo

ThinkSystem ST50 V2 server product overview

The ThinkSystem ST50 V2 is a one-socket tower server with an Intel Xeon-E or Pentium processor with up to eight cores and a 95-watt TDP. It was designed to support small- to medium-sized businesses, and it supports a limited number of configurations. It has the following features:

- Up to 128 GB in four UDIMM slots using 32 GB UDIMMs; 3222 MHz TruDDR4 with an Intel Xeon-E processor installed
- I/O expansion provides three PCIe slots (one PCIe 4.0 x16, one PCIe 3.0 x1, and one PCIe 3.0 x16)
- Up to two 3.5-inch simple-swap drive bays, one 2.5-inch simple-swap drive bay, and one M.2 NVME drive
A hybrid drive configuration of HDDs and SSDs is supported
- There are two machine types: the 7D8J and 7D8K with model type CTO1WW

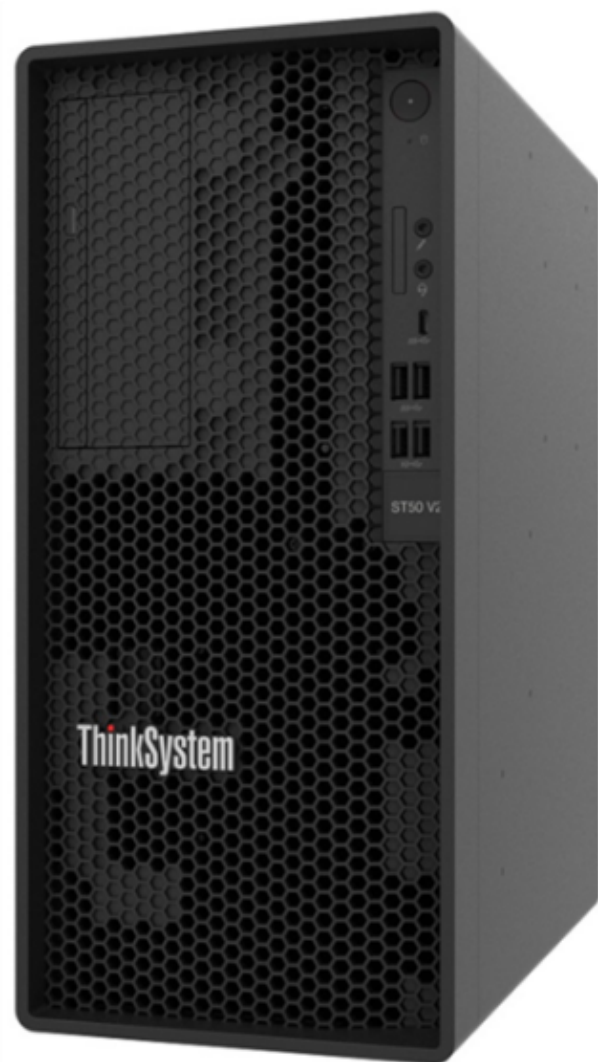

Front view

The following graphic shows the front of ThinkSystem ST50 V2 with one slim media bay.

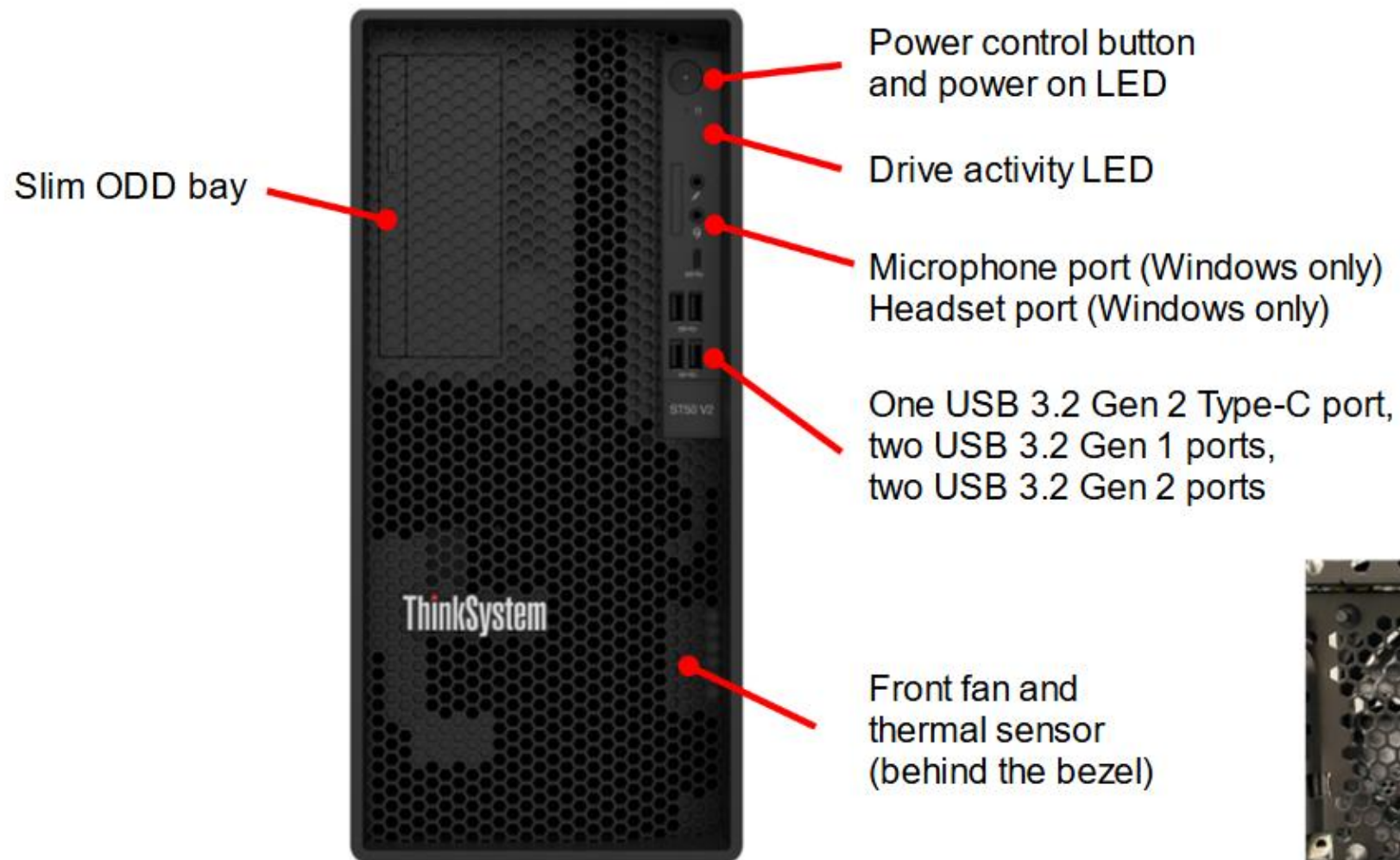

Rear view

The following graphic shows the rear of ST50 V2 with three PCIe slots and one fixed power supply.

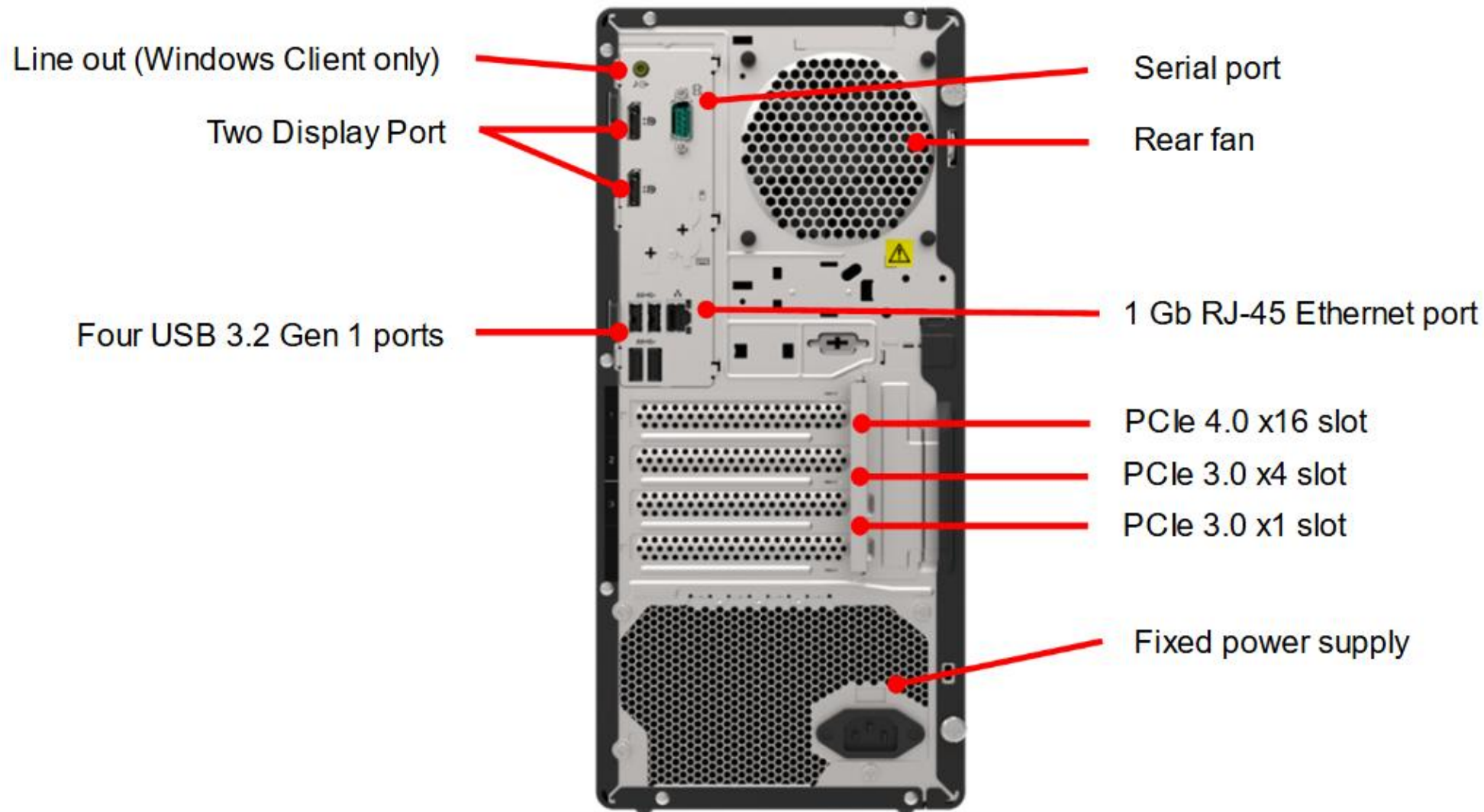

ST50 V2 internal view – without drive bays

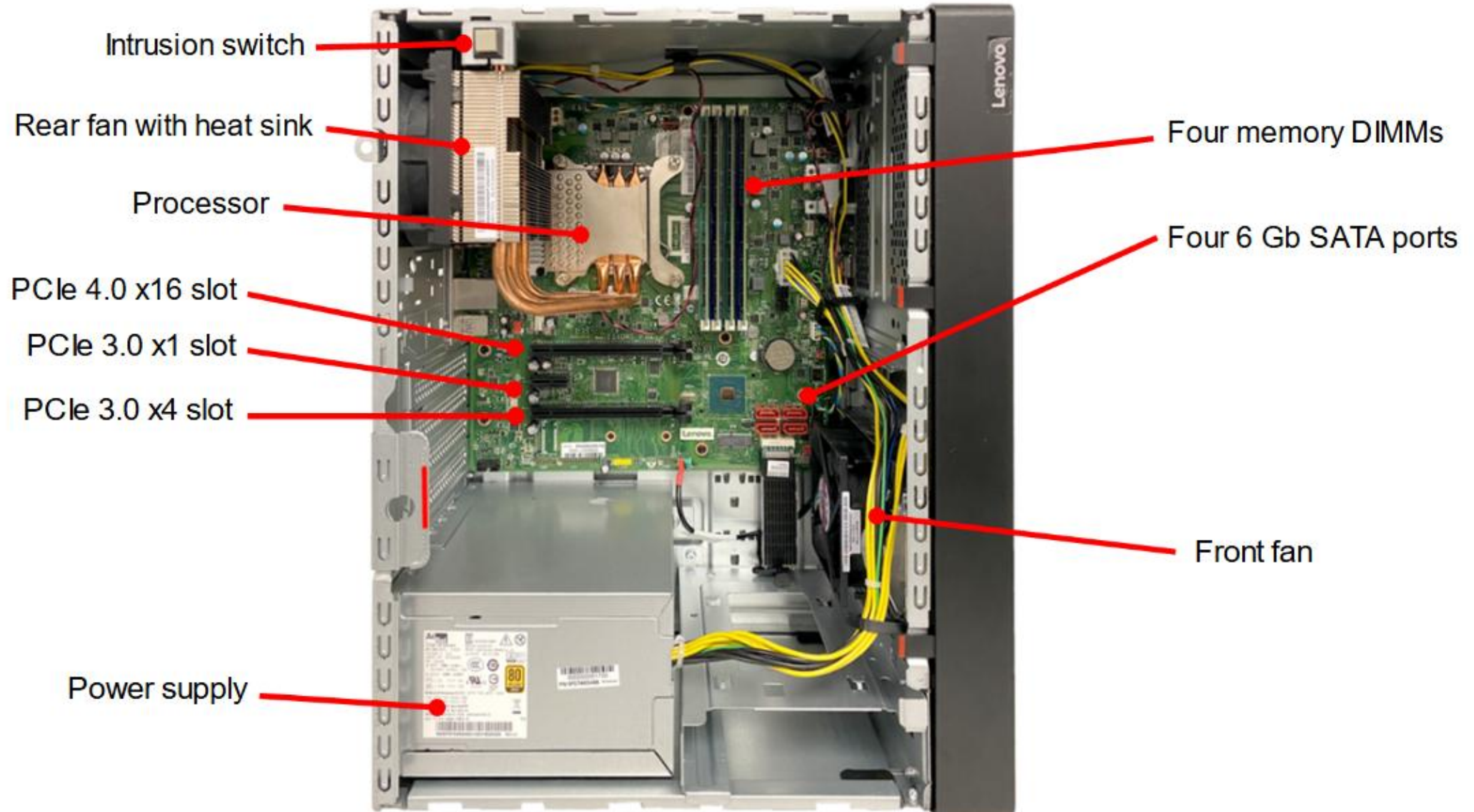

ST50 V2 internal view – with drive bays

The ST50 V2 supports up to two 3.5-inch drives, a 2.5-inch hard drive, a slim ODD drive, and an M.2 NVMe drive for internal storage. The drive bays are as follows:

- Drive bay 1: One 3.5-inch hard drive
- Drive bay 2: One 2.5-inch hard drive
- Drive bay 3: One 3.5-inch hard drive
- Drive bay 4: One slim SATA ODD bay
- One M.2 2280 NVMe PCIe standard M.2 module for a boot option

Notes: The ST50 V2 supports a zero-disk configuration.

To support a 2.5-inch hard drive on drive bays 1 or 3, an expansion frame must be used. (Click [HERE](#) for a demonstration)

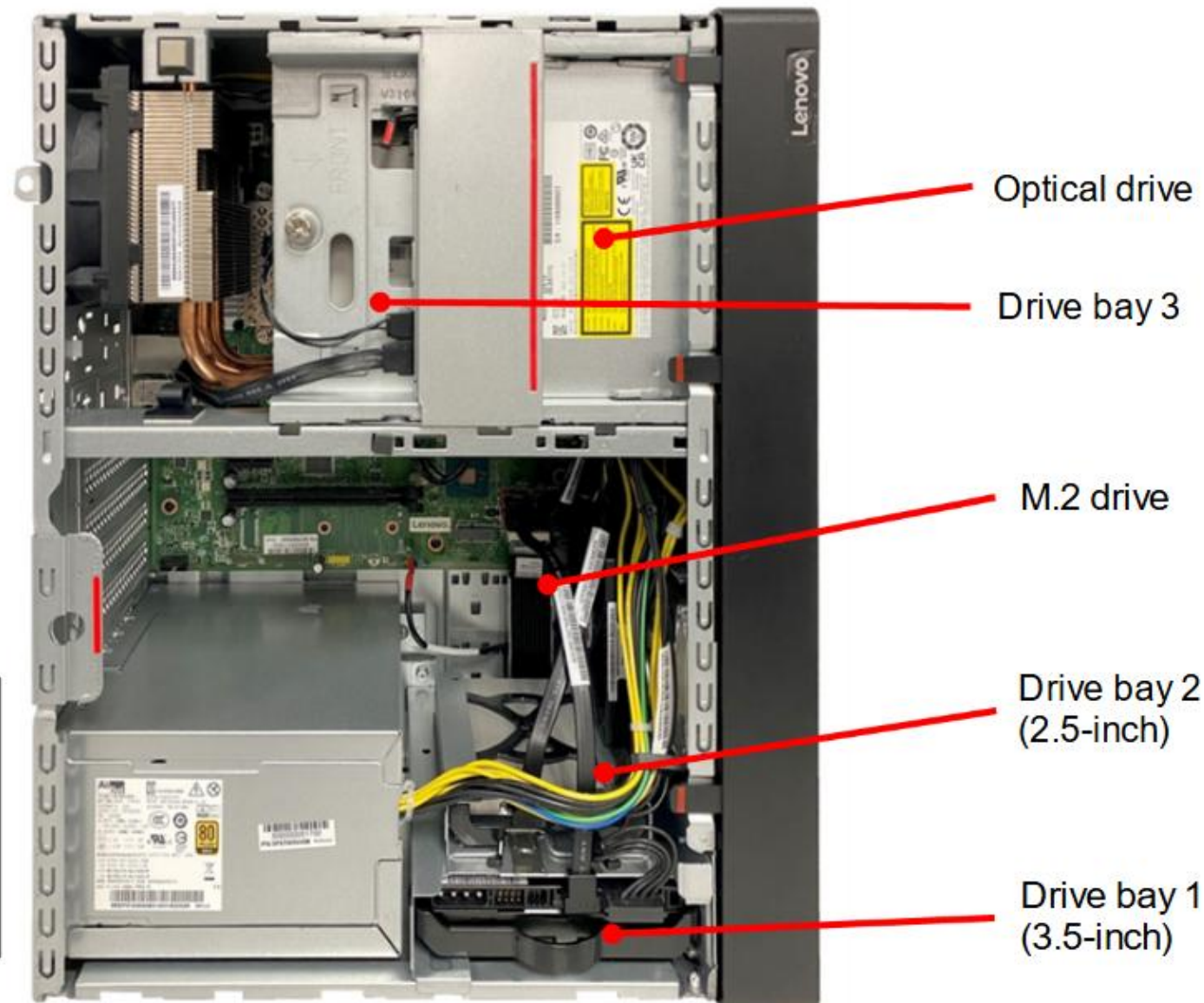

ThinkSystem ST50 V2 system board components

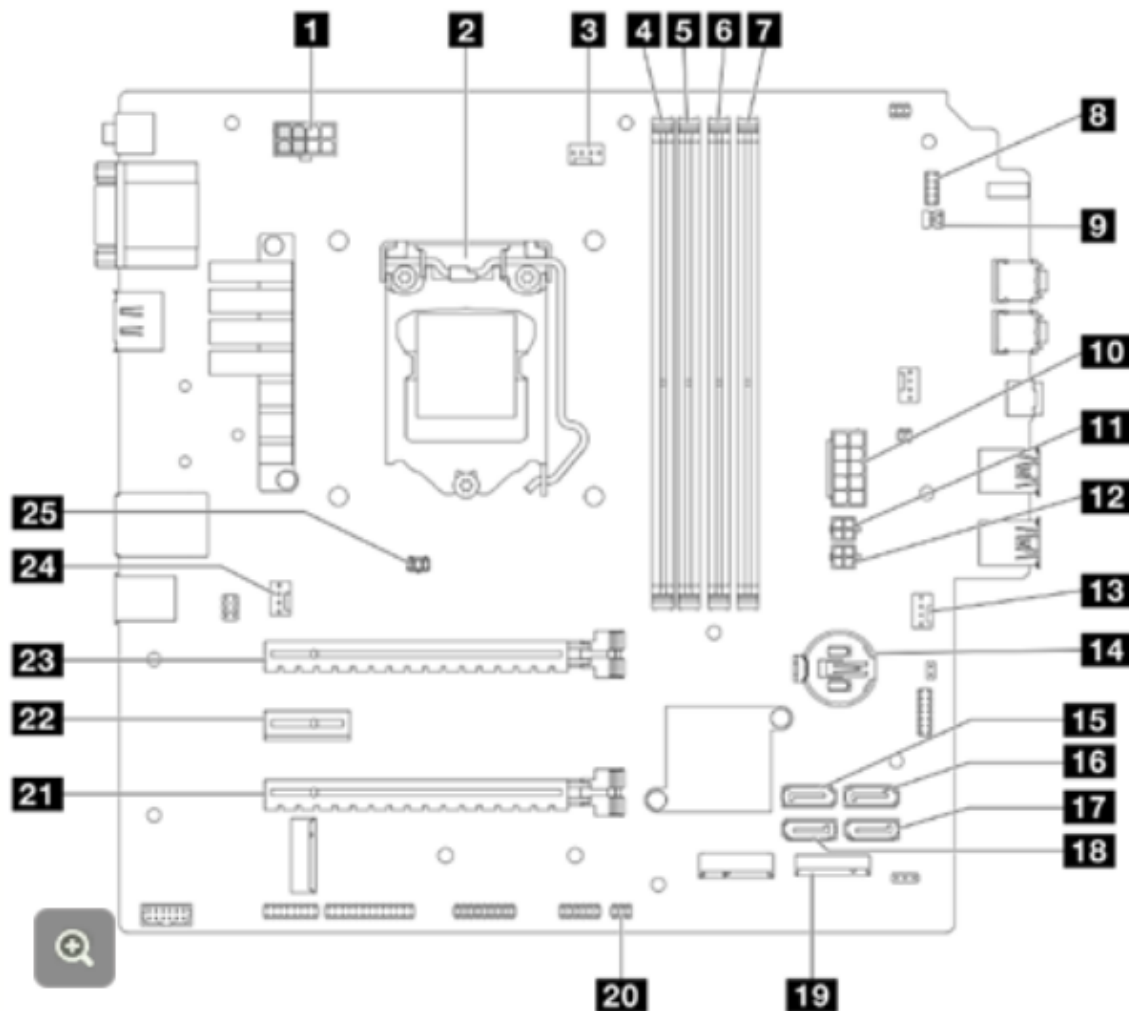

Label / Component

1 Processor power connector	14 3V CR2032 battery
2 Processor socket	15 SATA connector 3
3 Processor heat sink connector	16 SATA connector 4
4 Memory module slot 1	17 SATA connector 2
5 Memory module slot 2	18 SATA connector 1
6 Memory module slot 3	19 M.2 connector
7 Memory module slot 4	20 Thermal sensor connector
8 Power button with LED connector	21 PCIe slot 3
9 Mono amplifier connector	22 PCIe slot 2
10 System power connector	23 PCIe slot 1
11 SATA power 1 connector	24 Rear fan connector
12 SATA power 2 connector	25 Intrusion switch connector
13 Front fan connector	