

Product overview

Product description and front, rear, and inside views

Lenovo

Product overview

The ThinkSystem ST250 V3 is a 4U tower server that features a single Intel Xeon E2400 Series processor (Intel code name: Raptor Lake-E, Catlow platform). The ST250 V3 supports up to four PCIe slots including one PCIe 5.0 slot, four DIMM slots which support DDR5 memory, and 16 2.5-inch drives or eight 3.5-inch drives. The ST250 V3 also supports the Common Redundant Power Supply (CRPS).

There are three ST250 V3 machine types:

- 7DCE (three-year warranty)
- 7DCF (one-year warranty)
- 7DCG (three-year warranty, PRC only)



Front view (tower mode)

Front I/O module with
power button and
system LEDs

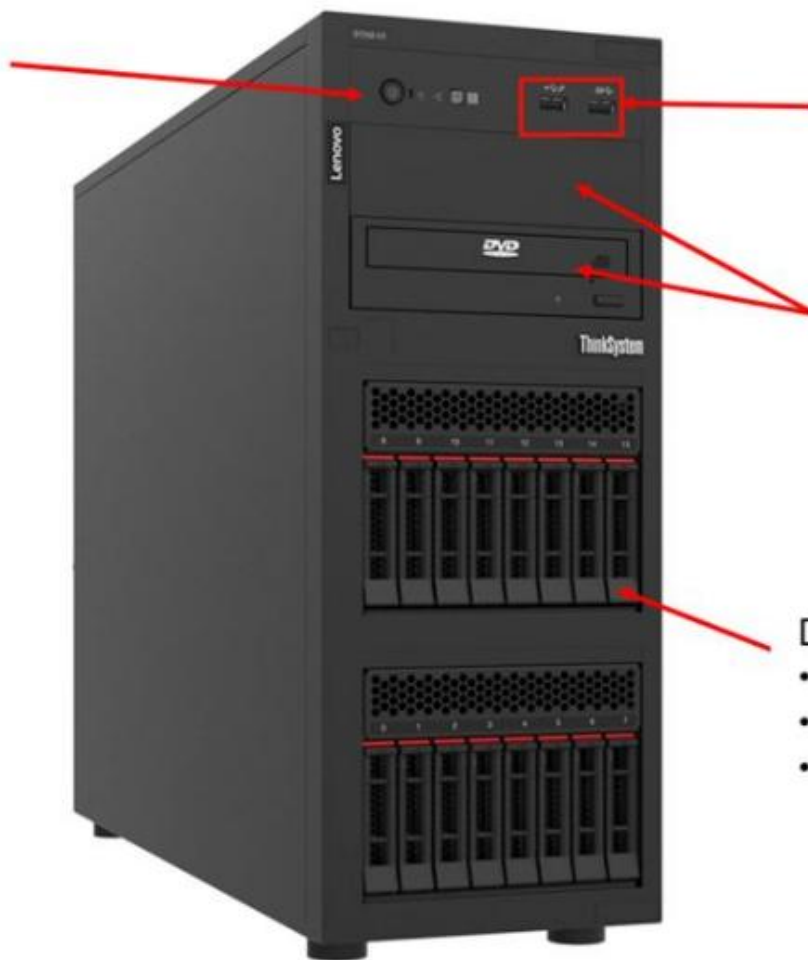

- Left: USB 2.0 port (shared with XCC mobile)
- Right: USB 3.2 Gen 1 port

Two media bays for
optical drives or tape
drives

Drive configurations:

- Up to 16 2.5-inch hot-swap drives
- Up to eight 3.5-inch hot-swap drives
- Up to eight 3.5-inch simple-swap drives

Front view (rack mode)



The ST250 V3 can be installed in a rack with an optional rack mount kit.

Rear view

Two hot-swap redundant CRPS (Platinum) / CRPS (Titanium) power supplies

- Left: VGA port
- Right: Serial port

Four USB 3.2 Gen 1 connectors

PCIe slots 1 to 4 (top to bottom)

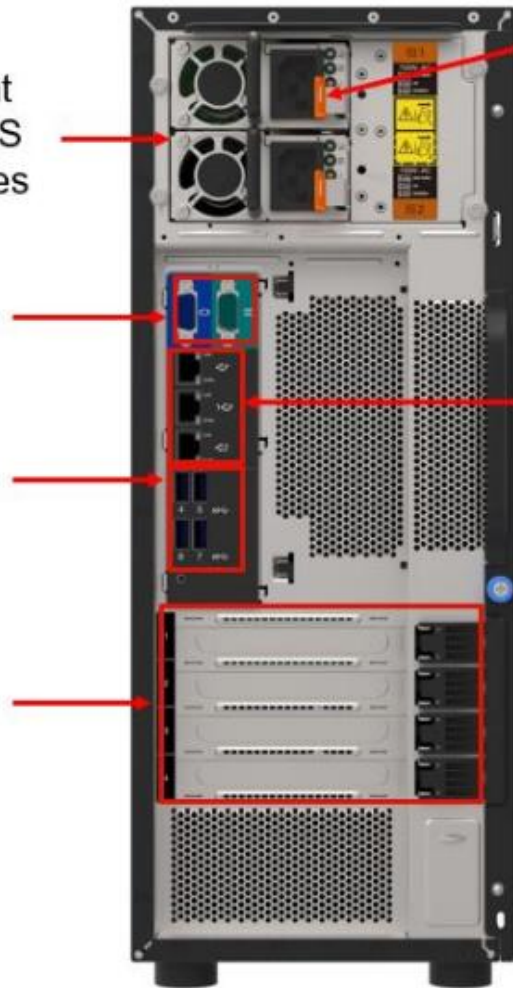

Note: The color of the CRPS release tab can vary on different systems

Top to bottom:

- Dedicated XCC management port
- Ethernet port 1 (shared with the XCC management port)
- Ethernet port 2



The ST250 V3 also supports a fixed power supply unit (PSU) configuration

Inside view

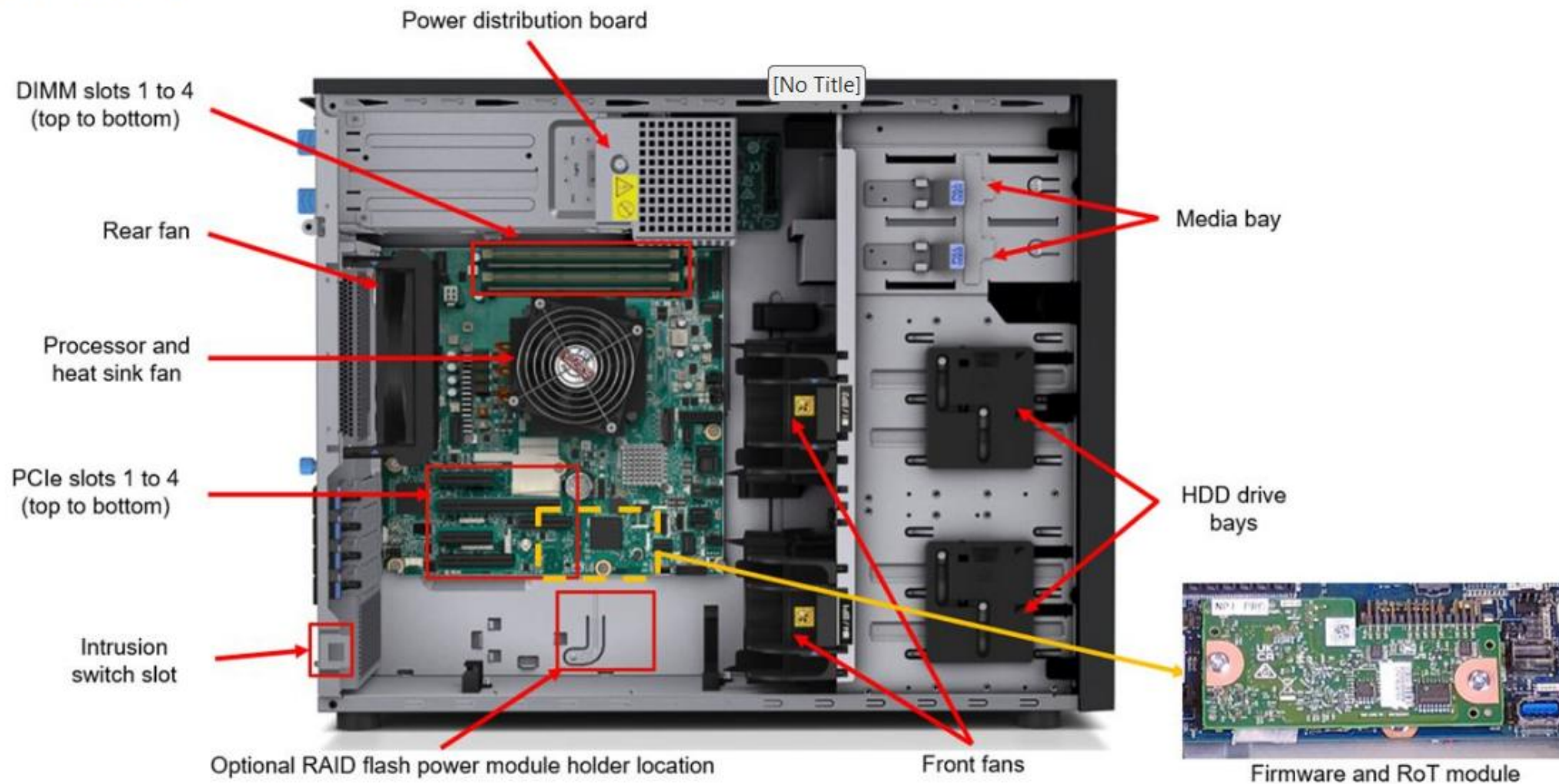

Note: For more information, refer to the Side view section of the ThinkSystem ST250 V3 User Guide on [Lenovo Support](#).